

**THE COUNCIL OF THE BOROUGH OF MILTON KEYNES
(THE COUNCIL OF THE BOROUGH OF MILTON KEYNES (CENTRAL
MILTON KEYNES) (ON-STREET STANDARD RATE PAY AND DISPLAY
AND PAY BY MOBILE PHONE PARKING PLACES AND VARIOUS
PERMITS) ORDER 2002) VARIATION ORDER (No.2) 2013**

The Council of the Borough of Milton Keynes ("the Council") in exercise of the powers of the said Council under Sections 45, 46, 49, 53 and Part IV of Schedule 9 of the Road Traffic Regulation Act 1984 ("the Act of 1984") and of all other enabling powers and after consultation with the chief officer of police in accordance with Part III of Schedule 9 hereby makes the following Order: -

PART 1

IMPLEMENTATION, CITATION AND DEFINITIONS

1. This Order shall come into operation on the 4th November 2013 and may be cited as "The Council of the Borough of Milton Keynes (The Council of the Borough of Milton Keynes (Central Milton Keynes) (On-Street Standard Rate Pay and Display and Pay By Mobile Phone Parking Places and Various Permits) Order 2002) Variation Order (No. 2) 2013".
2. Any reference in this Order to any enactment shall be construed as a reference to that enactment as amended by any subsequent enactment.
3. The plans annexed to this Order identify the lengths of road subject to this Order, provided that where there is any inconsistency between the plans and the Articles it is the wording of the Articles which shall prevail.
4. The plans annexed to this Order are hereby annexed to The Council of the Borough of Milton Keynes (Central Milton Keynes) (On-Street Standard Rate Pay and Display and Pay By Mobile Phone Parking Places and Various Permits) Order 2002 and form part of the Order.

PART 2

VARIATIONS

5. The Council of the Borough of Milton Keynes (Central Milton Keynes) (On-Street Standard Rate Pay and Display and Pay By Mobile Phone Parking Places and Various Permits) Order 2002 ("The Principal Order") is varied as provided by the following provisions of this Order:-
6. The following items are inserted into Schedule 1 of the Principal Order:-

(1) AVEBURY BOULEVARD, CENTRAL MILTON KEYNES -
THE NORTH-WEST VEHICULAR ACCESSWAY – NORTH-
WEST SIDE

PS102a From Secklow Gate to the porte cochere north-east of that point

PS102b From the porte cochere north-east of Secklow Gate to the porte cochere south-west of Lower Twelfth Street

AVEBURY BOULEVARD, CENTRAL MILTON KEYNES -
THE NORTH-WEST VEHICULAR ACCESSWAY – SOUTH-
EAST SIDE

PS102c From Secklow Gate to the porte cochere north-east of that point

PS102d From the porte cochere north-east of Secklow Gate to the access road onto Avebury Boulevard situated between Secklow Gate and Lower Twelfth Street

PS102e From the access road onto Avebury Boulevard (situated between Secklow Gate and Lower Twelfth Street) to the porte cochere south-west of Lower Twelfth Street

(2) MIDSUMMER BOULEVARD, CENTRAL MILTON KEYNES -
THE NORTH-WEST VEHICULAR ACCESSWAY – NORTH-
WEST SIDE

PS103a From the north-eastern side of the porte cochere situated north-east of the access road leading onto Midsummer Boulevard opposite South Fifth Street to the access road leading to Midsummer Boulevard opposite South Sixth Street

PS103b From the access road leading to Midsummer Boulevard opposite South Sixth Street to the south-western side of the porte cochere situated south-west of the access road leading onto Midsummer Boulevard opposite South Seventh Street

MIDSUMMER BOULEVARD, CENTRAL MILTON KEYNES -
THE NORTH-WEST VEHICULAR ACCESSWAY – SOUTH-
EAST SIDE

PS103c From the north-eastern side of the porte cochere situated north-east of the access road leading onto Midsummer Boulevard opposite South Fifth Street to the access road leading to Midsummer Boulevard opposite South Sixth Street

PS103d From the access road leading to Midsummer Boulevard opposite South Sixth Street to the south-western side of the porte cochere situated south-west of the access road leading onto Midsummer Boulevard opposite South Seventh Street

7. The following items are inserted into Schedule 2 of the Principal Order:-

(1) SILBURY BOULEVARD, CENTRAL MILTON KEYNES -
THE NORTH-WEST VEHICULAR ACCESSWAY - NORTH-
WEST SIDE

PS104a From its junction with Grafton Gate East to the porte cochere south-west of North Second Street

SILBURY BOULEVARD, CENTRAL MILTON KEYNES -
THE NORTH-WEST VEHICULAR ACCESSWAY - SOUTH-
EAST SIDE

PS104b From its junction with Grafton Gate East to the porte cochere south-west of North Second Street

SILBURY BOULEVARD, CENTRAL MILTON KEYNES -
THE SOUTH-EAST VEHICULAR ACCESSWAY - NORTH-
WEST SIDE

PS105a From its junction with Upper Second Street to the porte cochere north-east of Upper Second Street

SILBURY BOULEVARD, CENTRAL MILTON KEYNES -
THE SOUTH-EAST VEHICULAR ACCESSWAY - SOUTH-
EAST SIDE

PS105b From its junction with Upper Second Street to the porte cochere north-east of Upper Second Street

SILBURY BOULEVARD, CENTRAL MILTON KEYNES -
THE SOUTH-EAST VEHICULAR ACCESSWAY - NORTH-
WEST SIDE

PS106a From the porte cochere north-east of Upper Second Street to Upper Third Street

SILBURY BOULEVARD, CENTRAL MILTON KEYNES -
THE SOUTH-EAST VEHICULAR ACCESSWAY - SOUTH-
EAST SIDE

PS106b From the porte cochere north-east of Upper Second Street to Upper Third Street

(2) AVEBURY BOULEVARD, CENTRAL MILTON KEYNES -
THE NORTH-WEST VEHICULAR ACCESSWAY - NORTH-
WEST SIDE

PS107a From the north-east side of the porte cochere situated north-east of Grafton Gate to the un-

named access road parallel to Lower Second Street

**AVEBURY BOULEVARD, CENTRAL MILTON KEYNES -
THE NORTH-WEST VEHICULAR ACCESSWAY - SOUTH-
EAST SIDE**

PS107b From the north-east side of the porte cochere situated north-east of Grafton Gate to the un-named access road parallel to Lower Second Street

**AVEBURY BOULEVARD, CENTRAL MILTON KEYNES -
THE NORTH-WEST VEHICULAR ACCESSWAY - NORTH-
WEST SIDE**

PS108a From the un-named access road parallel to Lower Second Street to the south-west side of the porte cochere situated north-east of the un-named access road parallel to Lower Second Street

**AVEBURY BOULEVARD, CENTRAL MILTON KEYNES -
THE NORTH-WEST VEHICULAR ACCESSWAY - SOUTH-
EAST SIDE**

PS108b From the un-named access road parallel to Lower Second Street to the south-west side of the porte cochere situated north-east of the un-named access road parallel to Lower Second Street

**AVEBURY BOULEVARD, CENTRAL MILTON KEYNES -
THE NORTH-WEST VEHICULAR ACCESSWAY - NORTH-
WEST SIDE**

PS109a From the north-east side of the porte cochere situated north-east of the un-named access road parallel to Lower Second Street to the un-named access road parallel with Lower Third Street

**AVEBURY BOULEVARD, CENTRAL MILTON KEYNES -
THE NORTH-WEST VEHICULAR ACCESSWAY - SOUTH -
EAST SIDE**

PS109b From the north-east side of the porte cochere situated north-east of the un-named access road parallel to Lower Second Street to the un-named access road parallel with Lower Third Street

**AVEBURY BOULEVARD, CENTRAL MILTON KEYNES -
THE NORTH-WEST VEHICULAR ACCESSWAY - NORTH-
WEST SIDE**

PS110a From the un-named access road parallel with Lower Third Street to the south-west side of porte cochere south-west of Lower Fourth Street

AVEBURY BOULEVARD, CENTRAL MILTON KEYNES -
THE NORTH-WEST VEHICULAR ACCESSWAY - SOUTH-
EAST SIDE

PS110b From the un-named access road parallel with
Lower Third Street to the south-west side of porte
cochere south-west of Lower Fourth Street

AVEBURY BOULEVARD, CENTRAL MILTON KEYNES -
THE NORTH-WEST VEHICULAR ACCESSWAY - NORTH-
WEST SIDE

PS111a From the north-east side of porte cochere south-
west of Lower Fourth Street to Lower Fourth Street

AVEBURY BOULEVARD, CENTRAL MILTON KEYNES -
THE NORTH-WEST VEHICULAR ACCESSWAY - SOUTH-
EAST SIDE

PS111b From the north-east side of porte cochere south-
west of Lower Fourth Street to Lower Fourth Street

(3) GRAFTON PARK, CENTRAL MILTON KEYNES -
NORTH-WEST SIDE

PS112a From its junction with Grafton Gate for a distance
of approximately 33.5 metres in a north-easterly
direction

PS112b From a point approximately 38.9 metres north-east
of its junction with Grafton Gate for a distance of
approximately 34 metres in a north-easterly
direction

PS112c From its junction with Lower Fourth Street for a
distance of approximately 31 metres in a south-
westerly direction

PS112d From a point approximately 36.4 metres south-west
of its junction with Lower Fourth Street for a
distance of approximately 31.1 metres in a south-
westerly direction

(4) GRAFTON GATE EAST, CENTRAL MILTON KEYNES -
THE NORTH-EAST VEHICULAR ACCESSWAY - SOUTH-
WEST SIDE

PS113a Between Midsummer Boulevard and the access
road that leads onto Grafton Gate between
Midsummer Boulevard and Avebury Boulevard

GRAFTON GATE EAST, CENTRAL MILTON KEYNES -
THE NORTH-EAST VEHICULAR ACCESSWAY - NORTH-
EAST SIDE

PS113b Between Midsummer Boulevard and the access
road that leads onto Grafton Gate between

Midsummer Boulevard and Avebury Boulevard

(5) LOWER SECOND STREET, CENTRAL MILTON KEYNES -
SOUTH-WEST SIDE

PS114a From its junction with Midsummer Boulevard for a distance of approximately 30 metres in a south-easterly direction

PS114b From its junction with Grafton Park for a distance of approximately 16.2 metres in a north-westerly direction

LOWER SECOND STREET, CENTRAL MILTON KEYNES -
NORTH-EAST SIDE

PS114c From its junction with Midsummer Boulevard for a distance of approximately 7.7 metres in a south-easterly direction

PS114d From a point approximately 9.5 metres south-east of its junction with Midsummer Boulevard for a distance of approximately 12.7 metres in a south-easterly direction

PS114e From a point approximately 24 metres south-east of its junction with Midsummer Boulevard for a distance of approximately 5 metres in a south-easterly direction

PS114f From a point approximately 43 metres south-east of its junction with Midsummer Boulevard for a distance of approximately 8 metres in a south-easterly direction

PS114g From a point approximately 52.8 metres south-east of its junction with Midsummer Boulevard for a distance of approximately 10.8 metres in a south-easterly direction

PS114h From a point approximately 67.2 metres south-east of its junction with Midsummer Boulevard for a distance of approximately 11.2 metres in a south-easterly direction

(6) LOWER THIRD STREET, CENTRAL MILTON KEYNES -
THE SOUTH-WEST SIDE

PS115a From its junction with Midsummer Boulevard for a distance of approximately 7.5 metres in a south-easterly direction

PS115b From a point approximately 9.4 metres south-east of its junction with Midsummer Boulevard for a

distance of approximately 12.6 metres in a south-easterly direction

PS115c From a point approximately 23.8 metres south-east of its junction with Midsummer Boulevard for a distance of approximately 12.6 metres in a south-easterly direction

PS115d From a point approximately 37.2 metres south-east of its junction with Midsummer Boulevard for a distance of approximately 12.6 metres in a south-easterly direction

**LOWER THIRD STREET, CENTRAL MILTON KEYNES -
THE NORTH-EAST SIDE**

PS115e From its junction with Midsummer Boulevard for a distance of approximately 51.2 metres in a south-easterly direction

**LOWER THIRD STREET, CENTRAL MILTON KEYNES -
THE SOUTH-EAST SIDE**

PS115f From the south-western kerblines of Lower Third Street to the north-eastern kerblines of Lower Third Street

**(7) LOWER FOURTH STREET, CENTRAL MILTON KEYNES -
SOUTH-WEST SIDE**

PS116a From its junction with Midsummer Boulevard to the entrance to the Lower Fourth Street Car Park

PS116b From the entrance to the Lower Fourth Street Car Park to its junction with Grafton Park

PS116c From its junction with Avebury Boulevard for a distance of approximately 33.2 metres in a north-westerly direction

**(8) MIDSUMMER BOULEVARD, CENTRAL MILTON KEYNES -
THE SOUTH-EAST VEHICULAR ACCESSWAY – NORTH-
WEST SIDE**

PS117a From the north-east side of the porte cochere situated north-east of Grafton Gate to Lower Second Street

**MIDSUMMER BOULEVARD, CENTRAL MILTON KEYNES -
THE SOUTH-EAST VEHICULAR ACCESSWAY – SOUTH-
EAST SIDE**

PS117b From the north-east side of the porte cochere situated north-east of Grafton Gate to Lower Second Street

**MIDSUMMER BOULEVARD, CENTRAL MILTON KEYNES -
THE SOUTH-EAST VEHICULAR ACCESSWAY – NORTH-
WEST SIDE**

PS118a From Lower Second Street to the south-west side
of the porte cochere situated north-east of Lower
Second Street

**MIDSUMMER BOULEVARD, CENTRAL MILTON KEYNES -
THE SOUTH-EAST VEHICULAR ACCESSWAY – SOUTH-
EAST SIDE**

PS118b From Lower Second Street to the south-west side
of the porte cochere situated north-east of Lower
Second Street

**MIDSUMMER BOULEVARD, CENTRAL MILTON KEYNES -
THE SOUTH-EAST VEHICULAR ACCESSWAY – NORTH-
WEST SIDE**

PS119a From the north-east side of the porte cochere
situated north-east of Lower Second Street to the
south-west side of the porte cochere situated
north-east of Lower Third Street

**MIDSUMMER BOULEVARD, CENTRAL MILTON KEYNES -
THE SOUTH-EAST VEHICULAR ACCESSWAY – SOUTH-
EAST SIDE**

PS119b From the north-east side of the porte cochere
situated north-east of Lower Second Street to
Lower Third Street

**MIDSUMMER BOULEVARD, CENTRAL MILTON KEYNES -
THE SOUTH-EAST VEHICULAR ACCESSWAY – SOUTH-
EAST SIDE**

PS119c From Lower Third Street to the south-west side of
the porte cochere situated north-east of Lower
Third Street

**MIDSUMMER BOULEVARD, CENTRAL MILTON KEYNES -
THE SOUTH-EAST VEHICULAR ACCESSWAY – NORTH-
WEST SIDE**

PS120a From the north-east side of the porte cochere
situated north-east of Lower Third Street to Lower
Fourth Street

**MIDSUMMER BOULEVARD, CENTRAL MILTON KEYNES -
THE SOUTH-EAST VEHICULAR ACCESSWAY – SOUTH-
EAST SIDE**

PS120b From the north-east side of the porte cochere
situated north-east of Lower Third Street to Lower
Fourth Street

- (9) THE ACCESS ROAD PARALLEL TO LOWER SECOND STREET (BETWEEN AVEBURY BOULEVARD AND GRAFTON GATE), CENTRAL MILTON KEYNES - SOUTH-WEST SIDE

PS121a Its whole length from its junction with Avebury Boulevard

THE ACCESS ROAD PARALLEL TO LOWER SECOND STREET (BETWEEN AVEBURY BOULEVARD AND GRAFTON GATE), CENTRAL MILTON KEYNES - NORTH-EAST SIDE

PS121b Its whole length from its junction with Avebury Boulevard

- (10) THE ACCESS ROAD PARALLEL TO LOWER THIRD STREET (BETWEEN AVEBURY BOULEVARD AND GRAFTON GATE), CENTRAL MILTON KEYNES - SOUTH-WEST SIDE

PS122a Its whole length from its junction with Avebury Boulevard

THE ACCESS ROAD PARALLEL TO LOWER THIRD STREET (BETWEEN AVEBURY BOULEVARD AND GRAFTON GATE), CENTRAL MILTON KEYNES - NORTH-EAST SIDE

PS122b From its junction with Avebury Boulevard for a distance of approximately 12.9 metres in a north-westerly direction

8. The following items are inserted into Schedule 3 of the Principal Order:-

- (1) SILBURY BOULEVARD, CENTRAL MILTON KEYNES - THE NORTH-WEST VEHICULAR ACCESSWAY – NORTH-WEST SIDE

LP32a From its junction with Grafton Gate East to the porte cochere south-west of North Second Street

SILBURY BOULEVARD, CENTRAL MILTON KEYNES - THE NORTH-WEST VEHICULAR ACCESSWAY – SOUTH-EAST SIDE

LP32b From its junction with Grafton Gate East to the porte cochere south-west of North Second Street

SILBURY BOULEVARD, CENTRAL MILTON KEYNES - THE SOUTH-EAST VEHICULAR ACCESSWAY – NORTH-WEST SIDE

LP33a From its junction with Upper Second Street to the porte cochere north-east of Upper Second Street

SILBURY BOULEVARD, CENTRAL MILTON KEYNES - THE SOUTH-EAST VEHICULAR ACCESSWAY – SOUTH-EAST SIDE

LP33b From its junction with Upper Second Street to the

porte cochere north-east of Upper Second Street

**SILBURY BOULEVARD, CENTRAL MILTON KEYNES -
THE SOUTH-EAST VEHICULAR ACCESSWAY - NORTH-
WEST SIDE**

LP34a From the porte cochere north-east of Upper
Second Street to Upper Third Street

**SILBURY BOULEVARD, CENTRAL MILTON KEYNES -
THE SOUTH-EAST VEHICULAR ACCESSWAY - SOUTH-
EAST SIDE**

LP34b From the porte cochere north-east of Upper
Second Street to Upper Third Street

**(2) AVEBURY BOULEVARD, CENTRAL MILTON KEYNES -
THE NORTH-WEST VEHICULAR ACCESSWAY - NORTH-
WEST SIDE**

LP35a From the north-east side of the porte cochere
situated north-east of Grafton Gate to the un-
named access road parallel to Lower Second
Street

**AVEBURY BOULEVARD, CENTRAL MILTON KEYNES -
THE NORTH-WEST VEHICULAR ACCESSWAY - SOUTH-
EAST SIDE**

LP35b From the north-east side of the porte cochere
situated north-east of Grafton Gate to the un-
named access road parallel to Lower Second
Street

**AVEBURY BOULEVARD, CENTRAL MILTON KEYNES -
THE NORTH-WEST VEHICULAR ACCESSWAY - NORTH-
WEST SIDE**

LP36a From the un-named access road parallel to Lower
Second Street to the south-west side of the porte
cochere situated north-east of the un-named
access road parallel to Lower Second Street

**AVEBURY BOULEVARD, CENTRAL MILTON KEYNES -
THE NORTH-WEST VEHICULAR ACCESSWAY - SOUTH-
EAST SIDE**

LP36b From the un-named access road parallel to Lower
Second Street to the south-west side of the porte
cochere situated north-east of the un-named
access road parallel to Lower Second Street

**AVEBURY BOULEVARD, CENTRAL MILTON KEYNES -
THE NORTH-WEST VEHICULAR ACCESSWAY - NORTH-
WEST SIDE**

LP37a From the north-east side of the porte cochere
situated north-east of the un-named access road

parallel to Lower Second Street to the un-named access road parallel with Lower Third Street

**AVEBURY BOULEVARD, CENTRAL MILTON KEYNES -
THE NORTH-WEST VEHICULAR ACCESSWAY - SOUTH-
EAST SIDE**

LP37b From the north-east side of the porte cochere situated north-east of the un-named access road parallel to Lower Second Street to the un-named access road parallel with Lower Third Street

**AVEBURY BOULEVARD, CENTRAL MILTON KEYNES -
THE NORTH-WEST VEHICULAR ACCESSWAY - NORTH-
WEST SIDE**

LP38a From the un-named access road parallel with Lower Third Street to the south-west side of porte cochere south-west of Lower Fourth Street

**AVEBURY BOULEVARD, CENTRAL MILTON KEYNES -
THE NORTH-WEST VEHICULAR ACCESSWAY - SOUTH-
EAST SIDE**

LP38b From the un-named access road parallel with Lower Third Street to the south-west side of porte cochere south-west of Lower Fourth Street

**AVEBURY BOULEVARD, CENTRAL MILTON KEYNES -
THE NORTH-WEST VEHICULAR ACCESSWAY - NORTH-
WEST SIDE**

LP39a From the north-east side of porte cochere south-west of Lower Fourth Street to Lower Fourth Street

**AVEBURY BOULEVARD, CENTRAL MILTON KEYNES
THE NORTH-WEST VEHICULAR ACCESSWAY - SOUTH-
EAST SIDE**

LP39b From the north-east side of porte cochere south-west of Lower Fourth Street to Lower Fourth Street

**(3) GRAFTON PARK, CENTRAL MILTON KEYNES -
NORTH-WEST SIDE**

LP40a From its junction with Grafton Gate for a distance of approximately 33.5 metres in a north-easterly direction

LP40b From a point approximately 38.9 metres north-east of its junction with Grafton Gate for a distance of approximately 34 metres in a north-easterly direction

LP40c From its junction with Lower Fourth Street for a distance of approximately 31 metres in a south-westerly direction

LP40d From a point approximately 36.4 metres south-west of its junction with Lower Fourth Street for a distance of approximately 31.1 metres in a south-westerly direction

(4) GRAFTON GATE EAST, CENTRAL MILTON KEYNES -
THE NORTH-EAST VEHICULAR ACCESSWAY – SOUTH-
WEST SIDE

LP41a Between Midsummer Boulevard and the access road that leads onto Grafton Gate between Midsummer Boulevard and Avebury Boulevard

GRAFTON GATE EAST, CENTRAL MILTON KEYNES -
THE NORTH-EAST VEHICULAR ACCESSWAY – NORTH-
EAST SIDE

LP41b Between Midsummer Boulevard and the access road that leads onto Grafton Gate between Midsummer Boulevard and Avebury Boulevard

(5) LOWER SECOND STREET, CENTRAL MILTON KEYNES -
SOUTH-WEST SIDE

LP42a From its junction with Midsummer Boulevard for a distance of approximately 30 metres in a south-easterly direction

LP42b From its junction with Grafton Park for a distance of approximately 16.2 metres in a north-westerly direction

LOWER SECOND STREET, CENTRAL MILTON KEYNES -
NORTH-EAST SIDE

LP42c From its junction with Midsummer Boulevard, for a distance of approximately 7.7 metres in a south-easterly direction

LP42d From a point approximately 9.5 metres south-east of its junction with Midsummer Boulevard for a distance of approximately 12.7 metres in a south-easterly direction

LP42e From a point approximately 24 metres south-east of its junction with Midsummer Boulevard for a distance of approximately 5 metres in a south-easterly direction

LP42f From a point approximately 43 metres south-east of its junction with Midsummer Boulevard for a distance of approximately 8 metres in a south-easterly direction

LP42g From a point approximately 24 metres south-east of its junction with Midsummer Boulevard for a distance of approximately 5 metres in a south-easterly direction

LP42h From a point approximately 43 metres south-east of its junction with Midsummer Boulevard for a distance of approximately 8 metres in a south-easterly direction

(6) LOWER THIRD STREET, CENTRAL MILTON KEYNES -
THE SOUTH-WEST SIDE

LP43a From its junction with Midsummer Boulevard for a distance of approximately 7.5 metres in a south-easterly direction

LP43b From a point approximately 9.4 metres south-east of its junction with Midsummer Boulevard for a distance of approximately 12.6 metres in a south-easterly direction

LP43c From a point approximately 23.8 metres south-east of its junction with Midsummer Boulevard for a distance of approximately 12.6 metres in a south-easterly direction

LP43d From a point approximately 37.2 metres south-east of its junction with Midsummer Boulevard for a distance of approximately 12.6 metres in a south-easterly direction

LOWER THIRD STREET, CENTRAL MILTON KEYNES -
THE NORTH-EAST SIDE

LP43e From its junction with Midsummer Boulevard for a distance of approximately 51.2 metres in a south-easterly direction

LOWER THIRD STREET, CENTRAL MILTON KEYNES -
THE SOUTH-EAST SIDE

LP43f From the south-western kerbline of Lower Third Street to the north-eastern kerbline of Lower Third Street

(7) LOWER FOURTH STREET, CENTRAL MILTON KEYNES -
SOUTH-WEST SIDE

LP44a From its junction with Midsummer Boulevard to the entrance to the Lower Fourth Street Car Park

LP44b From the entrance to the Lower Fourth Street Car Park to its junction with Grafton Park

LP44c From its junction with Avebury Boulevard for a distance of approximately 33.2 metres in a north-westerly direction

(8) MIDSUMMER BOULEVARD, CENTRAL MILTON KEYNES -
THE SOUTH-EAST VEHICULAR ACCESSWAY – NORTH-
WEST SIDE

LP45a From the north-east side of the porte cochere situated north-east of Grafton Gate to Lower Second Street

MIDSUMMER BOULEVARD, CENTRAL MILTON KEYNES -
THE SOUTH-EAST VEHICULAR ACCESSWAY – SOUTH-
EAST SIDE

LP45b From the north-east side of the porte cochere situated north-east of Grafton Gate to Lower Second Street

MIDSUMMER BOULEVARD, CENTRAL MILTON KEYNES -
THE SOUTH-EAST VEHICULAR ACCESSWAY – NORTH-
WEST SIDE

LP46a From its junction with Lower Second Street to the south-west side of the porte cochere situated north-east of Lower Second Street

MIDSUMMER BOULEVARD, CENTRAL MILTON KEYNES -
THE SOUTH-EAST VEHICULAR ACCESSWAY – SOUTH-
EAST SIDE

LP46b From its junction with Lower Second Street to the south-west side of the porte cochere situated north-east of Lower Second Street

MIDSUMMER BOULEVARD, CENTRAL MILTON KEYNES -
THE SOUTH-EAST VEHICULAR ACCESSWAY – NORTH-
WEST SIDE

LP47a From the north-east side of the porte cochere situated north-east of Lower Second Street to the south-west side of the porte cochere situated north-east of Lower Third Street

MIDSUMMER BOULEVARD, CENTRAL MILTON KEYNES -
THE SOUTH-EAST VEHICULAR ACCESSWAY – SOUTH-
EAST SIDE

LP47b From the north-east side of the porte cochere situated north-east of Lower Second Street to Lower Third Street

MIDSUMMER BOULEVARD, CENTRAL MILTON KEYNES -
THE SOUTH-EAST VEHICULAR ACCESSWAY – SOUTH-
EAST SIDE

MAP FOR TRAFFIC REGULATION ORDER



KEY:



Standard Tariff Pay and Display Parking Places

PS102a TRO reference number

Map Referred to in The Council of The Borough of Milton Keynes
(The Council of The Borough of Milton Keynes (Central Milton Keynes)
(On-Street Standard Rate Pay and Display and Pay By Mobile Phone
Parking Places and Various Permits) Order 2002) Variation Order
(No.2) 2013

21579

Map 1

The common seal of the Council of the
Borough of Milton Keynes was hereunto
affixed in the presence of:

Principal Solicitor - Law and Governance



MAP FOR TRAFFIC REGULATION ORDER

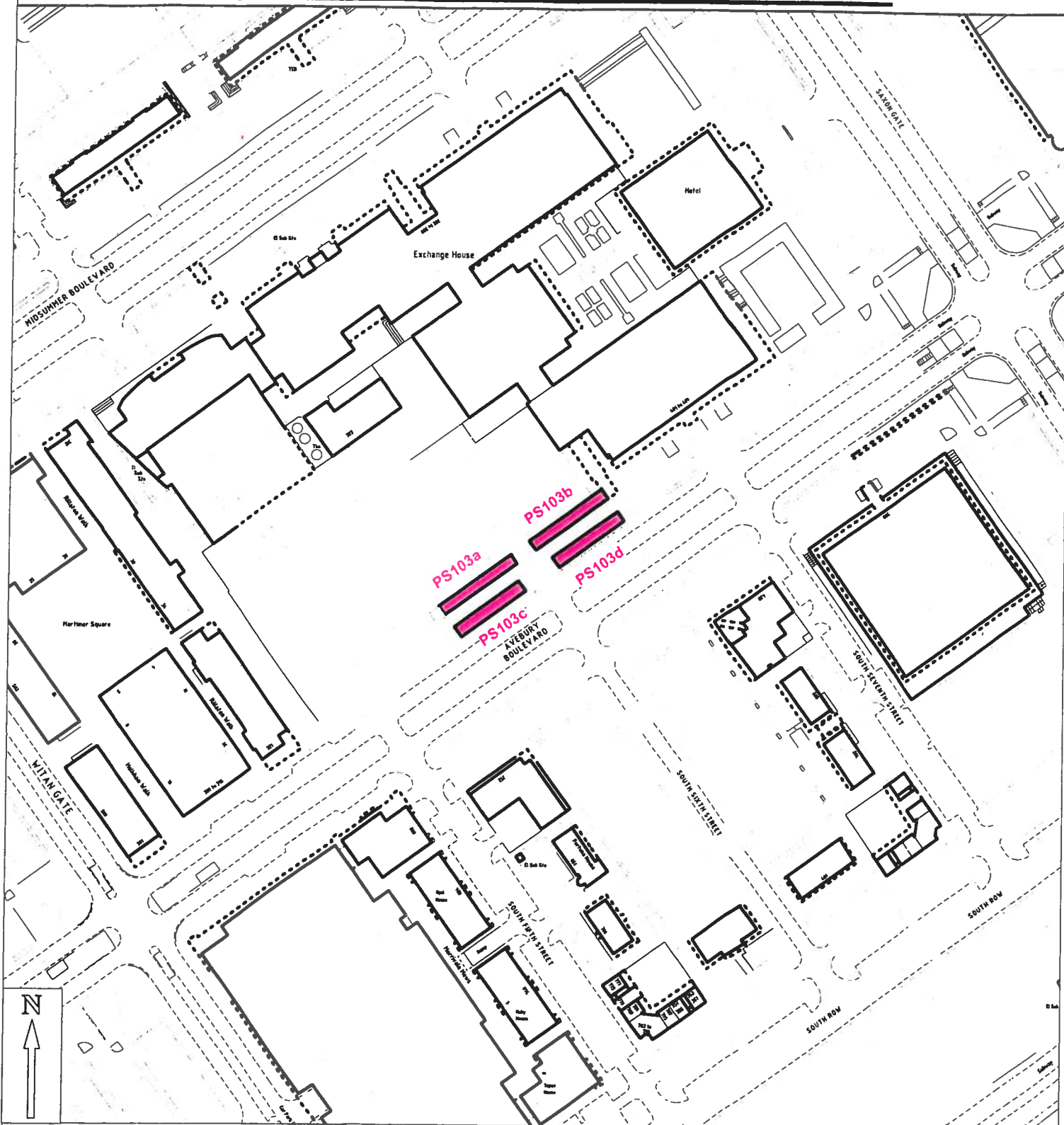

KEY:



Standard Tariff Pay and Display Parking Places

PS103a TRO reference number

Map Referred to in The Council of The Borough of Milton Keynes
(The Council of The Borough of Milton Keynes (Central Milton Keynes)
(On-Street Standard Rate Pay and Display and Pay By Mobile Phone
Parking Places and Various Permits) Order 2002) Variation Order
(No.2) 2013

Map 2

The common seal of the Council of the
Borough of Milton Keynes was hereunto
affixed in the presence of:

Principal Solicitor - Law and Governance



21579

MAP FOR TRAFFIC REGULATION ORDER



KEY:



Standard Tariff Pay and Display Parking Places

PS104a TRO reference number

Map Referred to in The Council of The Borough of Milton Keynes
(The Council of The Borough of Milton Keynes (Central Milton Keynes)
(On-Street Standard Rate Pay and Display and Pay By Mobile Phone
Parking Places and Various Permits) Order 2002) Variation Order
(No.2) 2013

Map 3

The common seal of the Council of the
Borough of Milton Keynes was hereunto
affixed in the presence of:

Principal Solicitor - Law and Governance

21579



MAP FOR TRAFFIC REGULATION ORDER



KEY:



Standard Tariff Pay and Display Parking Places

PS107a TRO reference number

Map Referred to in The Council of The Borough of Milton Keynes (The Council of The Borough of Milton Keynes (Central Milton Keynes) (On-Street Standard Rate Pay and Display and Pay By Mobile Phone Parking Places and Various Permits) Order 2002) Variation Order (No.2) 2013

Map 4

The common seal of the Council of the Borough of Milton Keynes was hereunto affixed in the presence of:

Principal Solicitor - Law and Governance



21579

MAP FOR TRAFFIC REGULATION ORDER



KEY:



Limited Parking for
Permit Holders Parking
Places

LP32a

TRO reference number

Map Referred to in The Council of The Borough of Milton Keynes
(The Council of The Borough of Milton Keynes (Central Milton Keynes)
(On-Street Standard Rate Pay and Display and Pay By Mobile Phone
Parking Places and Various Permits) Order 2002) Variation Order
(No.2) 2013

21579

Map 5

The common seal of the Council of the
Borough of Milton Keynes was hereunto
affixed in the presence of:

Principal Solicitor - Law and Governance



MAP FOR TRAFFIC REGULATION ORDER

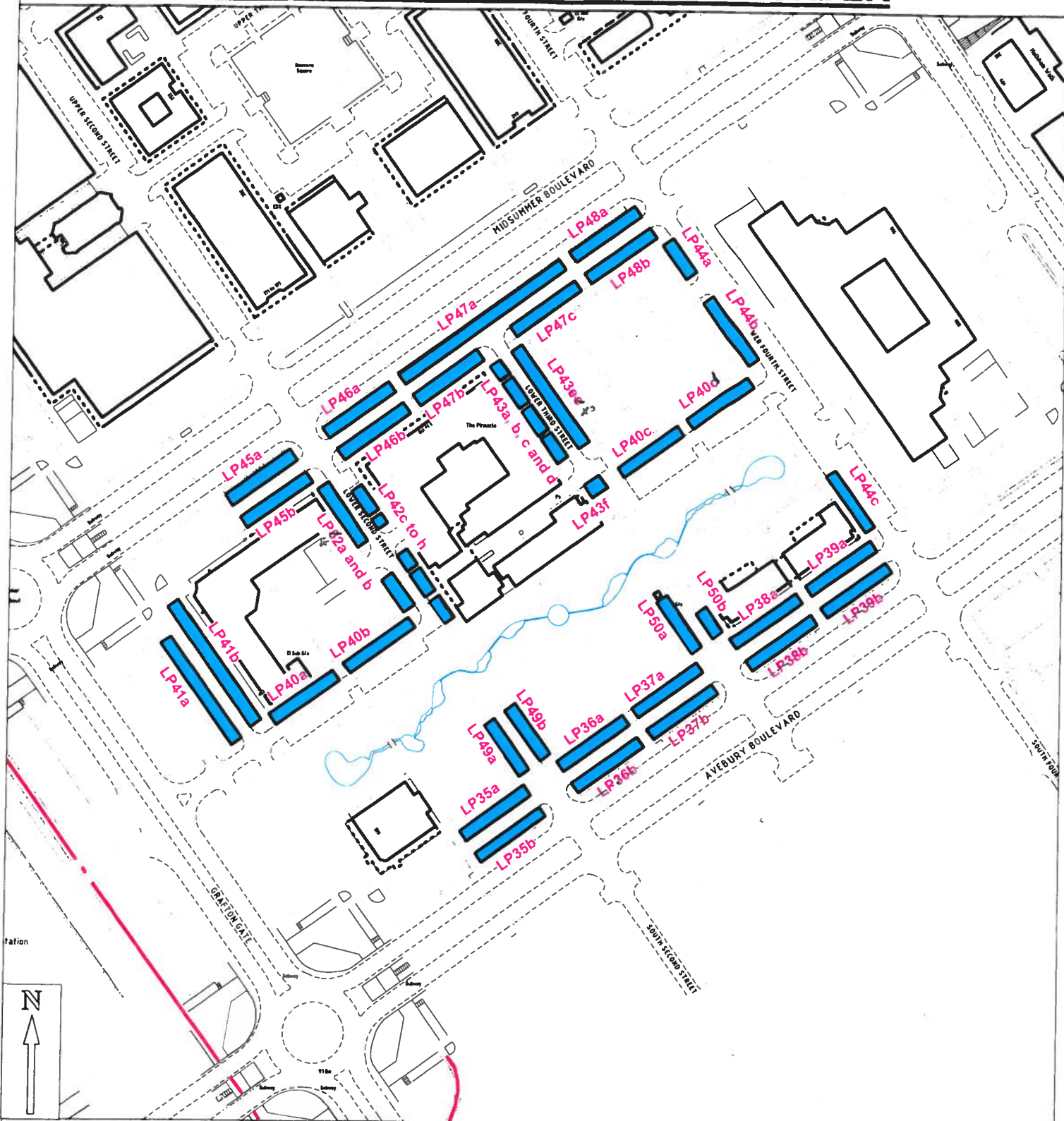

KEY:



Limited Parking for Permit Holders Parking Places

LP35a TRO reference number

Map Referred to in The Council of The Borough of Milton Keynes
(The Council of The Borough of Milton Keynes (Central Milton Keynes)
(On-Street Standard Rate Pay and Display and Pay By Mobile Phone
Parking Places and Various Permits) Order 2002) Variation Order
(No.2) 2013

Map 6

The common seal of the Council of the
Borough of Milton Keynes was hereunto
affixed in the presence of:

Principal Solicitor - Law and Governance

21579

LP47c From its junction with Lower Third Street to the south-west side of the porte cochere situated north-east of Lower Third Street

MIDSUMMER BOULEVARD, CENTRAL MILTON KEYNES -
THE SOUTH-EAST VEHICULAR ACCESSWAY – NORTH-
WEST SIDE

LP48a From the north-east side of the porte cochere situated north-east of Lower Third Street to Lower Fourth Street

MIDSUMMER BOULEVARD, CENTRAL MILTON KEYNES -
THE SOUTH-EAST VEHICULAR ACCESSWAY – SOUTH-
EAST SIDE

LP48b From the north-east side of the porte cochere situated north-east of Lower Third Street to Lower Fourth Street

- (9) THE ACCESS ROAD PARALLEL TO LOWER SECOND STREET (BETWEEN AVEBURY BOULEVARD AND GRAFTON GATE), CENTRAL MILTON KEYNES - SOUTH-WEST SIDE

LP49a Its whole length from its junction with Avebury Boulevard

THE ACCESS ROAD PARALLEL TO LOWER SECOND STREET (BETWEEN AVEBURY BOULEVARD AND GRAFTON GATE), CENTRAL MILTON KEYNES - NORTH-EAST SIDE

LP49b Its whole length from its junction with Avebury Boulevard

- (10) THE ACCESS ROAD PARALLEL TO LOWER THIRD STREET (BETWEEN AVEBURY BOULEVARD AND GRAFTON GATE), CENTRAL MILTON KEYNES - SOUTH-WEST SIDE

LP50a Its whole length from its junction with Avebury Boulevard

THE ACCESS ROAD PARALLEL TO LOWER THIRD STREET (BETWEEN AVEBURY BOULEVARD AND GRAFTON GATE), CENTRAL MILTON KEYNES - NORTH-EAST SIDE

LP50b From its junction with Avebury Boulevard for a distance of approximately 12.9 metres in a north-westerly direction

PART 3

REVOCATIONS

9. The following Order **IS HEREBY REVOKED** to the extent stated below:

The Council of the Borough of Milton Keynes (Central Milton Keynes)
(On-Street Standard Rate Pay and Display and
Pay By Mobile Phone Parking Places and Various Permits) Order 2002

Item PS98a is **HEREBY REVOKED IN ITS ENTIRETY** from Schedule 1

THE COMMON SEAL of the **COUNCIL OF THE
BOROUGH OF MILTON KEYNES** was hereunto
affixed this ^{29th} day of October 2013
in the presence of :-

.....
PRINCIPAL SOLICITOR - LAW & GOVERNANCE



21579